

## STAINLESS STEEL SHEAVE

**S.S. T304 WITH BRASS BUSHING  
PRECISION CAST**

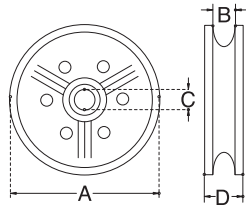

ITEM	A(SHEAVE)	B(ROPE)	C	D	WT (lb)
3130S-25	1"	1/4"	5/16"	11/16"	0.20
3130S-32	1-1/4"	5/16"	5/16"	11/16"	0.24
3130S-50	2"	3/8"	3/8"	13/16"	0.50
3130S-75	3"	1/2"	1/2"	13/16"	0.80
3130S-75-A	3"	5/8"	1/2"	1-1/8"	0.85
3130S-100	4"	5/8"	5/8"	15/16"	1.20
3130S-100-A	4"	3/4"	5/8"	15/16"	1.26
3130S-125	5"	3/4"	5/8"	1"	1.50

### FOR CABLE

3130S-75-C	3"	3/16"	1/2"	3/4"	0.88
3130S-100-C	4"	1/4"	5/8"	13/16"	1.30
3130S-125-C	5"	5/16"	5/8"	1"	2.25