

# ROUND RING

**S.S. T304  
FORMED AND WELDED**

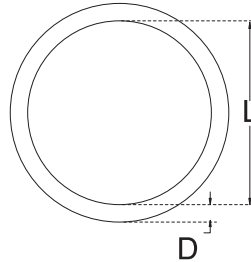

ITEM	D	L	WLL (lb)	ITEM	D	L	WLL (lb)
317S-320	1/8"	3/4"	125	317S-640	1/4"	1-9/16"	400
317S-325	1/8"	1"	125	317S-650	1/4"	2"	350
317S-330	1/8"	1-3/16"	100	317S-830	5/16"	1-3/16"	780
317S-340	1/8"	1-9/16"	100	317S-840	5/16"	1-9/16"	750
317S-425	5/32"	1"	300	317S-850	5/16"	2"	600
317S-430	5/32"	1-3/16"	280	317S-860	5/16"	2-3/8"	500
317S-440	5/32"	1-9/16"	250	317S-1050	3/8"	2"	1,100
317S-450	5/32"	2"	220	317S-1060	3/8"	2-3/8"	1,000
317S-520	3/16"	3/4"	500	317S-1080	3/8"	3-3/16"	800
317S-525	3/16"	1"	500	317S-10100	3/8"	4"	600
317S-530	3/16"	1-3/16"	300	317S-1380	1/2"	3-3/16"	1,750
317S-540	3/16"	1-9/16"	300	317S-13100	1/2"	4"	1,600
317S-550	3/16"	2"	250	317S-13120	1/2"	4-3/4"	1,400
317S-625	1/4"	1"	600	317S-1680	5/8"	3-3/16"	
317S-630	1/4"	1-3/16"	500	317S-38100	1-1/2"	4"	