

STEMBALL SWAGE

S.S. T316 COLD FORGED

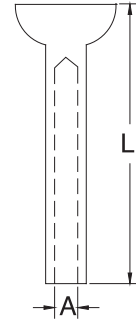

ITEM	A (WIRE)	L	AFTER SWAGE
78081S-03	1/8"	1.25"	0.19"
78081S-05	3/16"	1.38"	0.25"
78081S-06	1/4"	1.90"	0.31"
78081S-08	5/16"	2.30"	0.43"
78081S-10	3/8"	2.75"	0.56"